

REGISTERED PROFESSIONAL LAND SURVEYOR
LAKE GENEVA, WISCONSIN

£



LOT 16

17



- φ — IRON PIPE FOUND
- — IRON PIPE PLACED
- — CONCRETE MONUMENT
- x — SPIKE
- — WOODEN STAKE PLACED

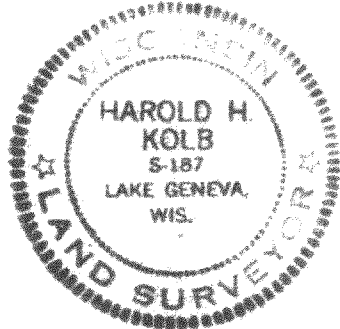

Lot 16, Charl-Mar Subdivision,
located in the Northwest $\frac{1}{4}$ of the
Northeast $\frac{1}{4}$ of Section 1, T3N, 216E,
Walworth County, Wisconsin.

I, HAROLD H. KOLB, DO HEREBY CERTIFY THAT I HAVE SURVEYED THE PROPERTY HEREON DESCRIBED ACCORDING TO THE OFFICIAL RECORDS, AND THAT THE PLAT HEREON IS A CORRECT REPRESENTATION OF THE LOT LINES.

Harold H. Kolb
HAROLD H. KOLB
WISCONSIN REGISTERED LAND SURVEYOR, S-187
DATE Nov. 14, 1973

GCH-16

316-116